

## RTM AND RTM LIGHT ACCESSORIES

On order to complete our RTM equipment range and to accompany all of your RTM projects, Matrasur Composites offers a complete set of **RTM and RTM Light Accessories** including: inserts, connectors, seals, channel profiles, among others.

### Seals and channel profiles:

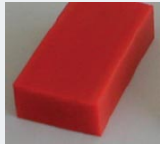

Ref.: 3391  
Wing seal channel profile for vacuum. Groove: 26x13mm. Supplied in 25m coils.



Ref.: 3340  
Red dynamic seal channel profile. Supplied in 25m coils.



Ref.: 4530  
Resin flow channel profile. Supplied in 25m coils.

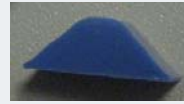

Ref.: 6438  
Small resin flow channel profile (section half as big as that of ref. 4530).



Ref.: 1680  
Vacuum seal wing profile in neoprene. Fits 26x13mm groove. Supplied in 25m coils.



Ref.: 5895  
Vacuum seal wing profile in silicone. Fits 26x13mm groove. Supplied in 25m coils.



Ref.: 1114  
Dynamic silicone seal. Adjustable sealing pressure, safer mould opening, seals on vertical draft face and self-adjusting around difficult flange profiles. Supplied in 25m coils.



Ref.: 6439  
V section seal. Alternative to the dynamic seal. Fits all moulds made with the dynamic seal channel profile. Offers a smaller seal contact area with the mould flange for higher efficiency, especially if flange has gelcoat applied. Supplied in 25m coils.



Ref.: 2056  
Dynamic seal installation kit Including: seal mould insert, nylon connection tube, nylon connection tube former, and silicone jointing tube.

### Accessories:



Ref.: 6316  
Universal insert and clip.



Ref.: 2146-view-uni  
Resin vacuum catchpot with view lid. Stainless steel body with sealed tapered fittings for easy disconnection after cure. Capacity: 1 litre.



Ref.: 6318  
10mm vacuum connection adaptor for universal insert. Alternative to resin catchpot.



Ref.: 6319 et 6319-6mm  
10mm/6mm resin feed connection adaptor for universal insert.



Ref.: 6315  
Adaptor for tube 3/4" on mould via the universal insert. Hose tail for adaptor: ref. 6028.

## RTM AND RTM LIGHT ACCESSORIES

### Options:



Ref.: 3202  
Green silicone mushroom seal.  
Fits 10x5mm groove.  
Gives a long moulding cycle life.  
Designed for 1mm seal compression.  
Supplied in 25m coils.



Ref.: 0002  
Mushroom seal channel profile.  
Groove: 10x5mm.  
Supplied in 25m coils.



Ref.: 6328  
Blank plug for universal insert.



**Ref.: 0580-Uni**  
**New** model of pneumatic ejector head with open/close control (ref. 1949-uni).  
Assy-0365: Kit ejector+insert+control



Ref.: 5797  
Mould pressure sensor type PV Sensor. Use with PV Sensor kit (ref.: 5801): PV Sensor+universal insert+plug+adaptor+control+power supply).



Ref.: 5855  
Injection head type Turbo Autosprue with nylon tube for resin - standard.  
For heavy duty resin feed, ref. 5856.



Ref.: 3228  
Venturi vacuum pump for mould manufacturing.  
Equipped with option for dynamic seal: ref.: 3229.



Ref.: 3370  
Latch clamp to be screwed to mould edge wooden frame of welded to steel frame. To assist closure of peripheral vacuum seal.



Ref.: TBC-RW/AH  
Cone locator for mould building.



Ref.: TBC-RW/AH  
Silicone form for universal insert positioning on resin flow channel (for the moment, only adapted to "bigger" resin channel ref. 4530).



VGR0010: 0.15 and 0.3 cm  
VGR0011: 0.46 and 0.6cm  
VGR0012: 0.8 and 0.95 cm  
Waxing balls (3 references according to size).

### Consumables:



Ref.: 0008-BOX (1mm)  
Calibration wax available in 1 to 2mm thick sheets (ref. 0010-BOX). Supplied in boxes of 8x0.18m<sup>2</sup> sheets/box.



Ref.: NONP-0144  
Yellow modelling wax. Supplied in blocks of 675kg.



Ref.: 1082  
Tooling tissue (1 layer).



Ref.: 0214  
10mm nylon pipe.



Ref.: 6335 (25mm)  
Roving tape 25mm and 50mm (ref.: 6336).

**RTM AND RTM LIGHT ACCESSORIES**

Overall view of RTM mould equipped with accessories listed above and their product reference:

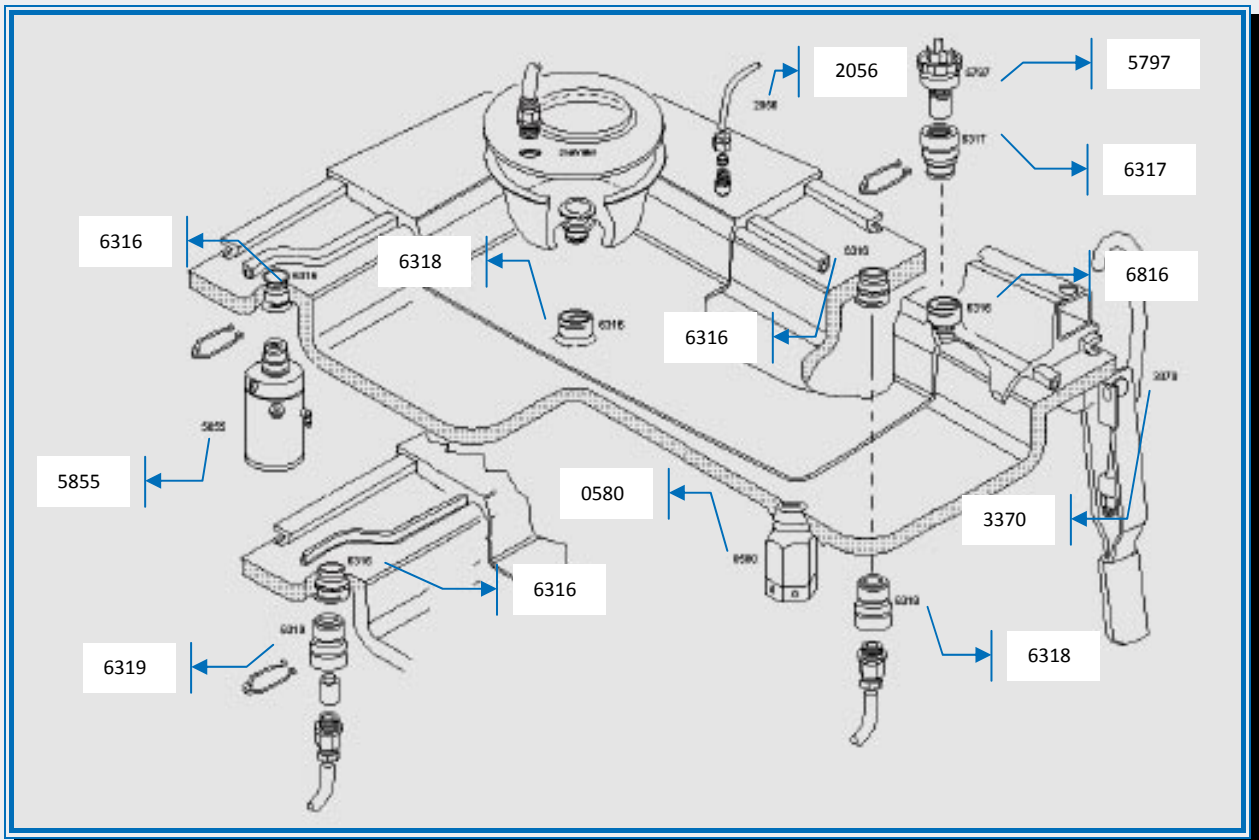

For more information or to order, contact the AFTER-SALES DEPARTMENT of MATRASUR Composites:

Fabien VALCK  
After-Sales  
Tel.: +33 (0) 1 69 801 808  
Fax: +33 (0) 1 69 806 806  
[sav@matrasurcomposites.com](mailto:sav@matrasurcomposites.com)